

TABLET
LESSONS

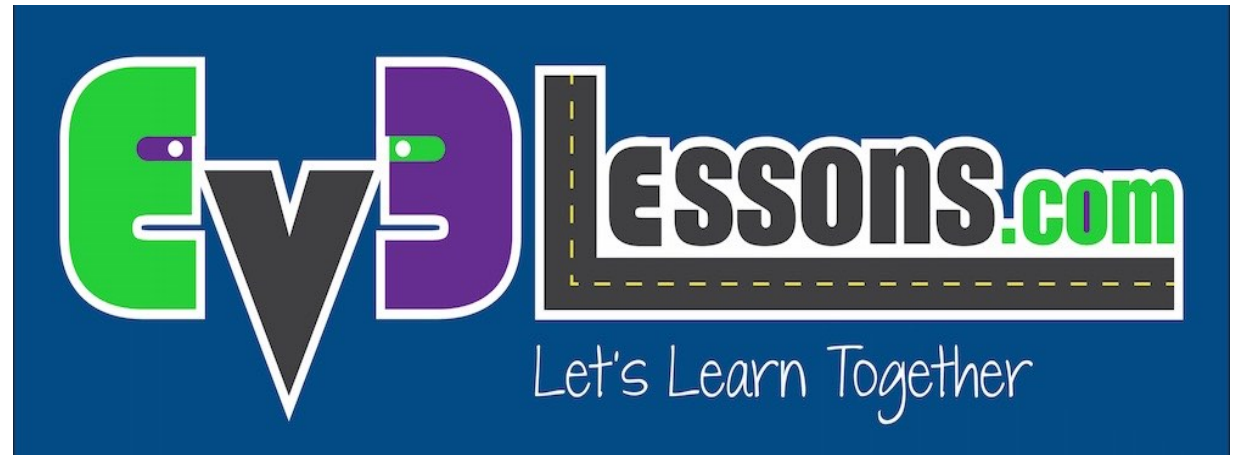

CONNECTING A BRICK

By Sanjay and Arvind Seshan



Lesson Objectives

1. Learn how to connect a brick to the App

Tap on “No EV3 Brick” in App

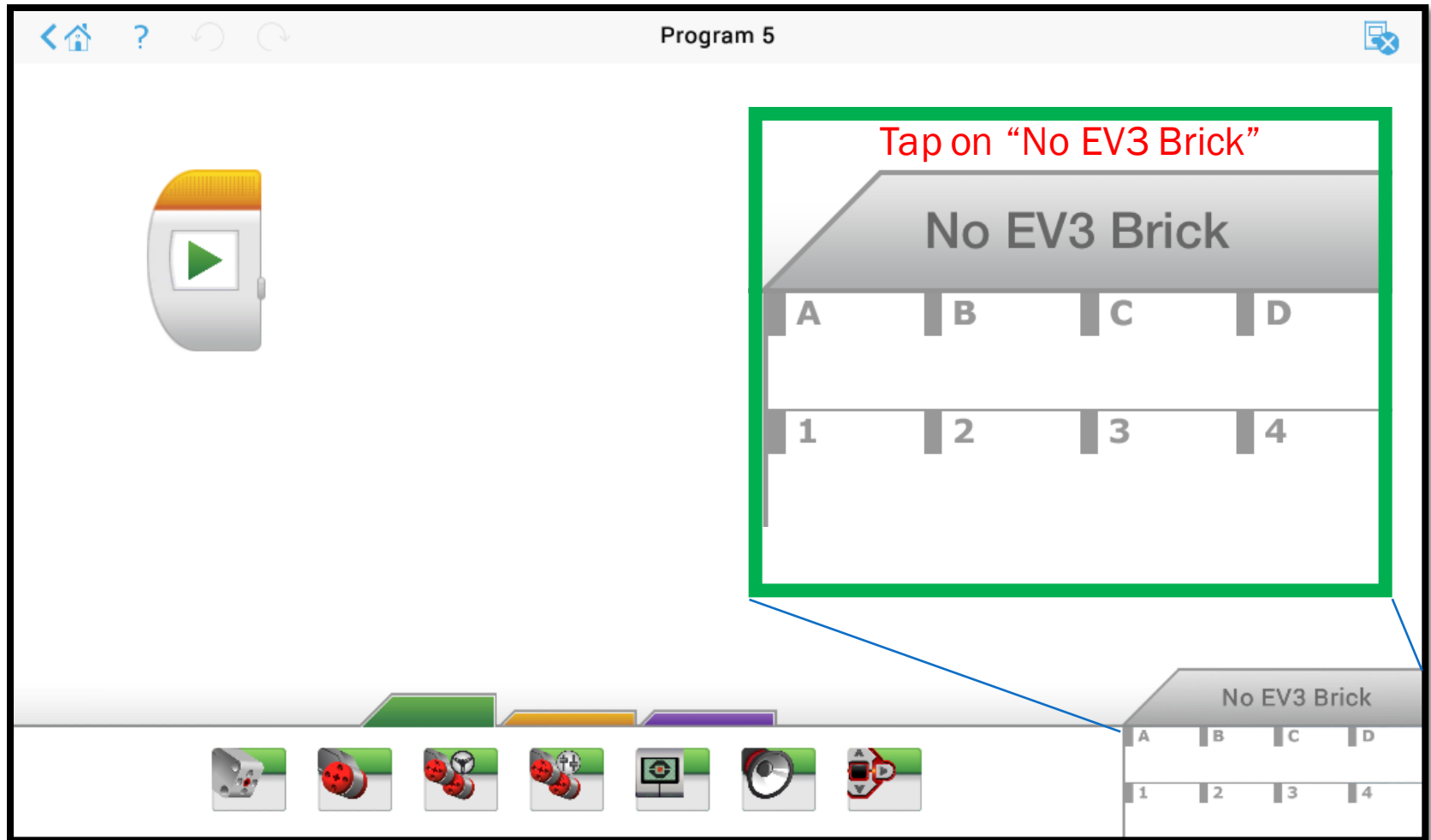

Click on Available Bricks

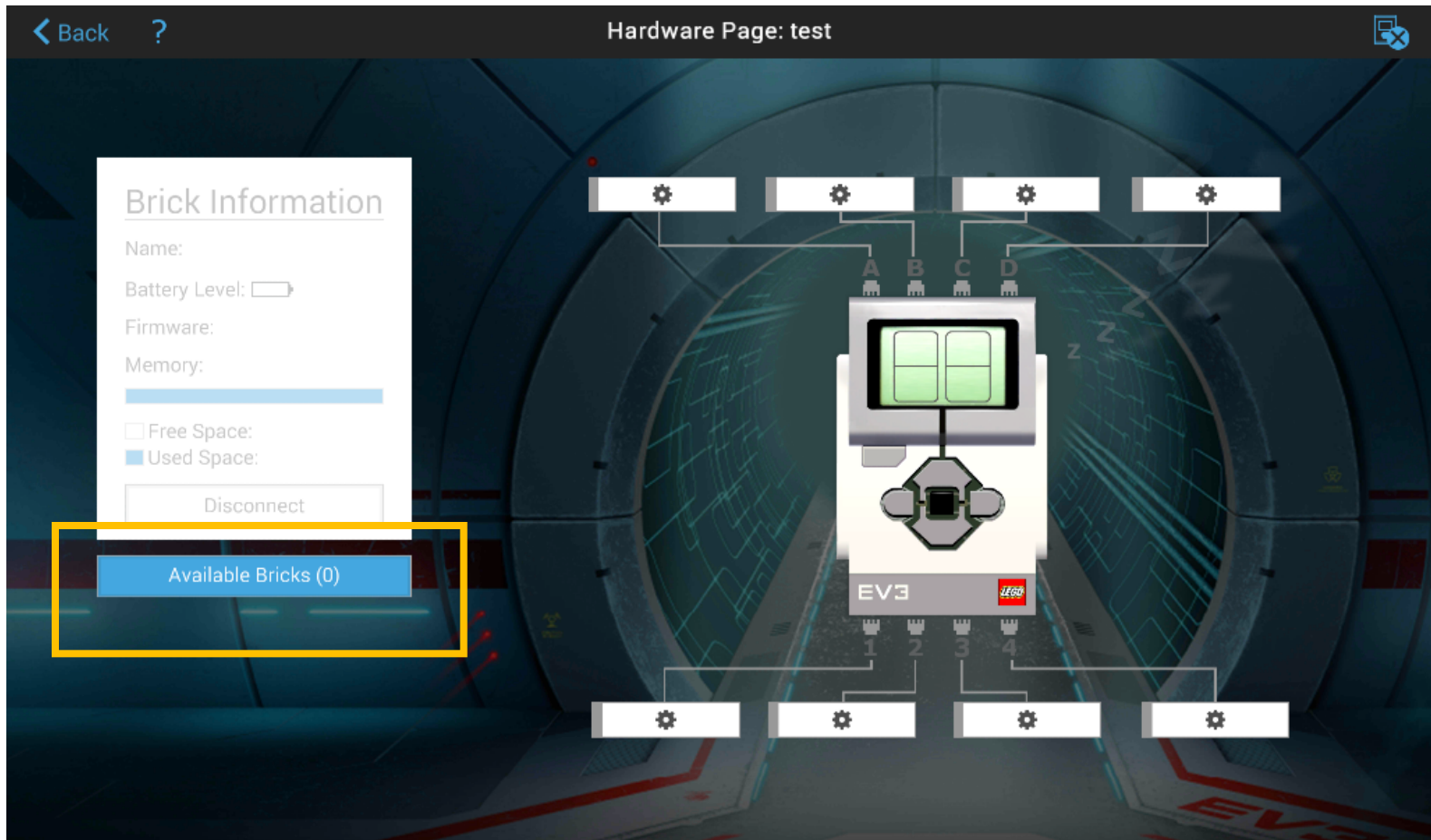

Turn on Brick and Follow Instructions on Pop-Up Screen in App

The screenshot shows the 'Hardware Page: test' in the EV3Lessons app. On the left, a 'Brick Information' panel displays fields for Name, Battery Level, Firmware, and Memory. Below these are checkboxes for 'Free Space' and 'Used Space', and a 'Disconnect' button. A blue bar at the bottom of this panel shows 'Available Bricks (0)'. A yellow-bordered pop-up window titled 'Connect EV3 Brick to tablet' is centered on the screen. It contains a three-step instruction list and a 'Connect' button. The background of the app shows a LEGO EV3 brick connected to a tablet, with various ports and settings visible.

Hardware Page: test

Brick Information

Name:

Battery Level:

Firmware:

Memory:

Free Space:

Used Space:

Disconnect

Available Bricks (0)

Connect EV3 Brick to tablet

1. On your EV3 Brick, go to Settings and open Bluetooth.
2. Enable Bluetooth and verify that iPhone / iPad / iPod is not enabled.
3. Connect your EV3 Brick to this tablet. Make sure the name you select in the list matches the name of your EV3 Brick.

Connect

[More Help](#)

Pair the EV3 with the Tablet

EV3 Pairing Instructions

- 1 On your EV3 P-Brick accept to pair with your Android device:
- 2 Accept the Passkey "1234"



Connect to the Brick (Match the Name)

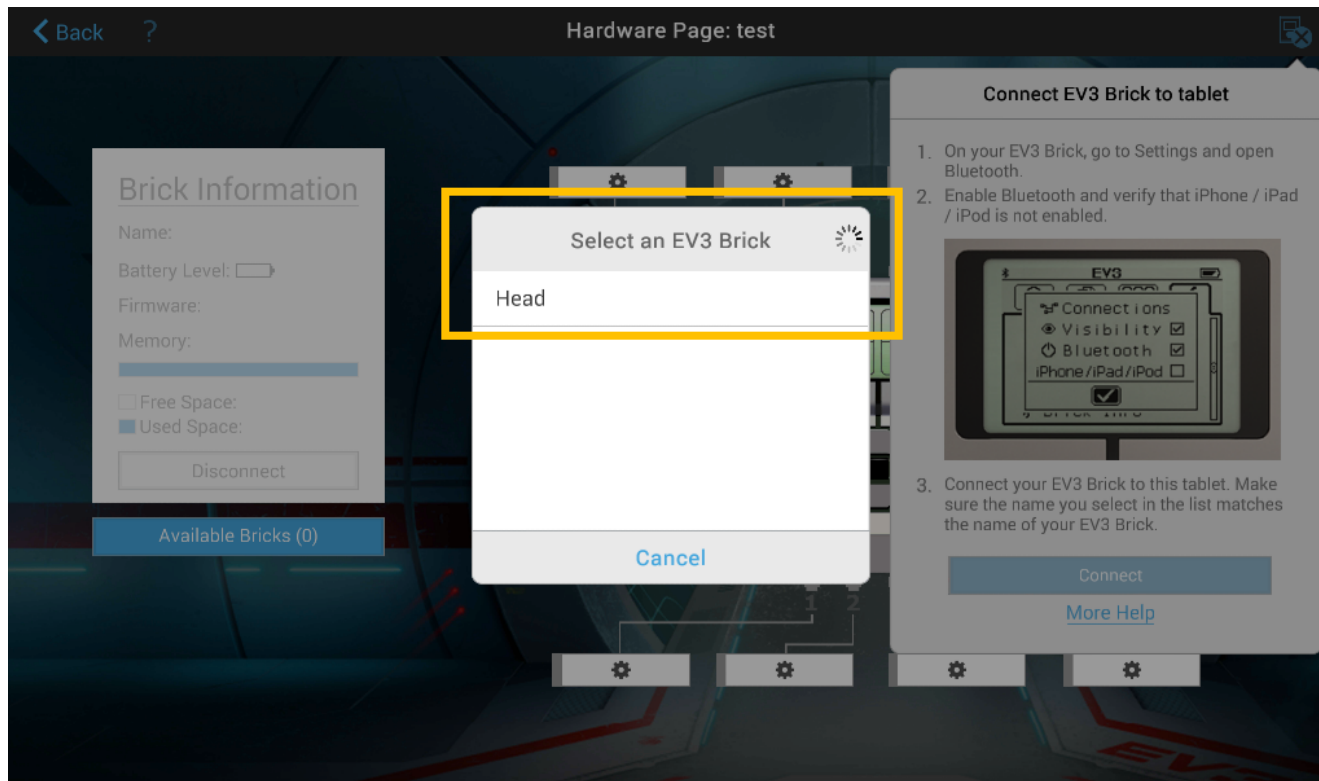

There is Now 1 Available Brick

< Back ?

Hardware Page: test

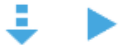

The screenshot displays the EV3 software interface. On the left, a 'Brick Information' panel provides details about the connected brick:

- Name: [Head](#)
- Battery Level:
- Firmware: V1.09E
- Memory:
- Free Space: 4 MB
- Used Space: 2 MB
- Disconnect button

Below the 'Disconnect' button, a yellow box highlights a button labeled 'Available Bricks (1)'. The central part of the interface shows a 3D model of the EV3 brick with various ports labeled (A, B, C, D, 1, 2, 3, 4) and gear icons representing connected sensors or motors.

Credits

- This tutorial was created by Sanjay Seshan and Arvind Seshan
- More lessons are available at www.ev3lessons.com



This work is licensed under a [Creative Commons Attribution-NonCommercial-ShareAlike 4.0 International License](https://creativecommons.org/licenses/by-nc-sa/4.0/).